

# Trewince Farm HOLIDAY PARK

## Holiday Home Spec' Sheet

Nestling in glorious Cornish countryside our superb holiday homes offer stunning views across our farm and into the rolling landscape beyond. We are ideally placed for you to take advantage of several award winning beaches - you can try our 7 bays in 7 days challenge. Should you fancy a break from the beach the Eden Project plus a host of leisure parks, historic towns and attractions are but a short hop away.

### Luxury Facilities are Standard at Trewince

At Trewince Farm Holiday Park we know that our great quality accommodation will help make your holiday special. Tastefully furnished, our modern caravan holiday homes have everything you need to make your stay truly relaxing and memorable. The caravans are sited in a lovingly tended garden area and have their own allotted parking space plus a shared space for visitors.

Catering for up to six people each caravan has crockery, cutlery and utensils, microwave, gas oven, fridge, and kettle. The spacious lounge offers a double pull out bed and television. Family shower room fitted with shower, hand basin and dual flush WC. Larger vans have separate WC.

We supply pillows and duvets but we ask guests to provide sheets, pillowcases, duvet covers, towels and tea-towels.

All of our accommodation is non-smoking and strictly pet free.

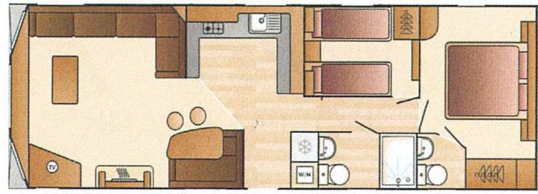

Burgundy 36x12 - 2 Bed

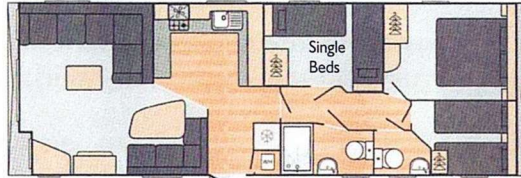

Burgundy 36x12 - 3 Bed

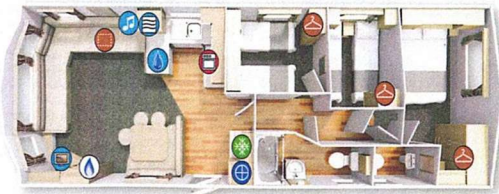

Rio Gold 37x12 - 3 Bed



Ryedale 32x12 - 2 Bed

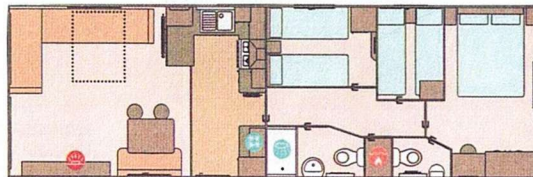

Ryedale 39x12 - 3 Bed

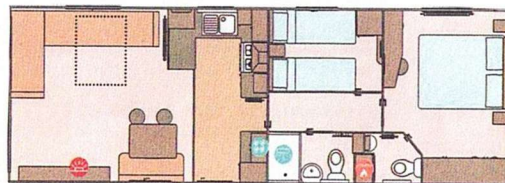

DIAMOND

GOLD

PLATINUM

# HOLIDAY CARAVAN TARIFF 2022

DIAMOND 2020 BURGUNDY LUXURY with Outside Decking and Patio Doors - 36'x12' 2 Bed Ensuite (30) 3 Bed (27,28,29)		GOLD 2021 RYEDALE 2 Bed Ensuite - 32'x12' (4,5,6) and 2018 RIO GOLD 3 Bed Ensuite - 37'x12' (7)		PLATINUM 2022 RYEDALE 3 Bed Ensuite 39'x12' (1) 2 Bed - 36'x12' (2,3)	
Caravan Number	27,28,29,30	Caravan Number	4,5,6,7	Caravan Number	1,2,3
Dates: Fri-Fri	£	Dates: Sat-Sat	£	Dates: Sat-Sat	£
1st April	615	LOW	2nd April	595	615/605
8th April	650		9th April	635	650/645
15th April	650		EASTER	16th April	635
22nd April	650	23rd April		635	650/645
29th April	615	LOW	30th April	595	615/605
6th May	615		7th May	595	615/605
13th May	615		14th May	595	615/605
20th May	615	WHITSUN	21st May	595	615/605
27th May	725		28th May	705	725/715
3rd June	705	MID	4th June	685	705/695
10th June	705		11th June	685	705/695
17th June	705		18th June	685	705/695
24th June	705	HIGH	25th June	685	705/695
1st July	705		2nd July	685	705/695
8th July	705		9th July	685	705/695
15th July	930	HIGH	16th July	910	930/920
22nd July	930		23rd July	910	930/920
29th July	930		30th July	910	930/920
5th August	930	HIGH	6th August	910	930/920
12th August	930		13th August	910	930/920
19th August	930		20th August	910	930/920
26th August	930	MID	27th August	910	930/920
2nd September	705		3rd September	685	705/695
9th Sept-7th Oct	615	LOW	10th Sept-8th Oct	595	615/605
14th October	615		15th October	595	615/605
21st October	680	HALF TERM	22nd October	660	680/670